

\$684,900 - 37 3410 Ste. Anne Trail, Rural Lac Ste. Anne County

MLS® #E4417802

\$684,900

4 Bedroom, 2.50 Bathroom, 2,157 sqft

Rural on 0.18 Acres

Windmill Harbour, Rural Lac Ste. Anne County, AB

Welcome to the gated community of Windmill Harbor, the most unique community in Lac Ste Anne & Alberta Beach. This immaculate showhome features a stunning floorplan and offers spectacular lake views and backs onto an environmental reserve. This property includes 4 bedroom, is fully finished top to bottom and has been upgraded throughout. The main level features a 20ft vaulted ceiling with massive windows allowing for tons of natural light, spacious living room, perfectly situated dining room and a clean modern kitchen. The upper level is where you will find a beautiful bonus room that overlooks the entire lac ste anne lake. This home comes fully finished, fully landscaped and is move in ready! Many other lots available to add your own touches if you're looking to build in this perfect community that will include community amenities, pickle ball courts, outdoor bbq area, marina with extra boat slips, hiking trails and so much more. Perfect all year round for recreational use or full time living.

Built in 2021

Essential Information

MLS® #

E4417802

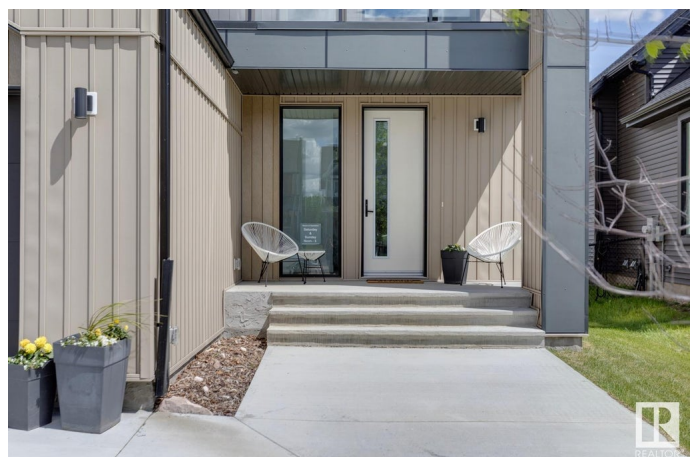

Price	\$684,900
Bedrooms	4
Bathrooms	2.50
Full Baths	2
Half Baths	1
Square Footage	2,157
Acres	0.18
Year Built	2021
Type	Rural
Sub-Type	Detached Single Family
Style	2 Storey
Status	Active

Community Information

Address	37 3410 Ste. Anne Trail
Area	Rural Lac Ste. Anne County
Subdivision	Windmill Harbour
City	Rural Lac Ste. Anne County
County	ALBERTA
Province	AB
Postal Code	T0E 0A1

Amenities

Features	Air Conditioner, Deck
----------	-----------------------

Interior

Interior Features	ensuite bathroom
Heating	Forced Air-1, Natural Gas
Stories	3
Has Basement	Yes
Basement	Full, Finished

Exterior

Exterior	Wood
Exterior Features	Backs Onto Lake, Beach Access, Boating, Environmental Reserve, Fenced, Gated Community, Golf Nearby, Lake Access Property, Lake View, Landscaped, No Back Lane, Playground Nearby, Private Setting, Shopping Nearby, Waterfront Property
Construction	Wood

Foundation Concrete Perimeter

Additional Information

Date Listed January 13th, 2025
Days on Market 231
Zoning Zone 71
HOA Fees 220
HOA Fees Freq. Monthly

DATA IS DEEMED RELIABLE BUT IS NOT GUARANTEED ACCURATE BY THE REALTORS® ASSOCIATION OF EDMONTON. COPYRIGHT 2025 BY THE REALTORS® ASSOCIATION OF EDMONTON. ALL RIGHTS RESERVED.Trademarks are owned or controlled by the Canadian Real Estate Association (CREA) and identify real estate professionals who are members of CREA (REALTOR®, REALTORS®) and/or the quality of services they provide (MLS®, Multiple Listing Service®)
Listing information last updated on September 1st, 2025 at 5:17am MDT